

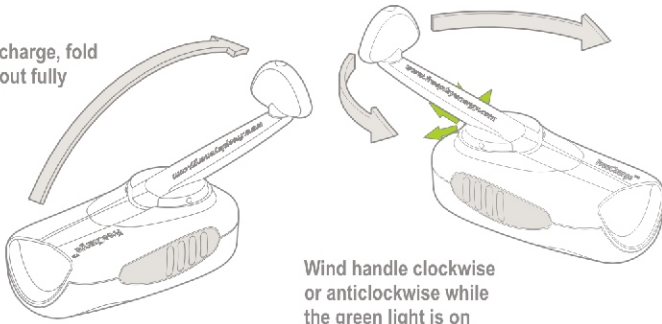

To self-charge, fold handle out fully



Wind handle clockwise or anticlockwise while the green light is on

The Freeplay Eco-Charge FreeCharge 12V , delivers instant power to cellphones and other personal electronic devices.

With the Freeplay FreeCharge 12V you will never be without power in an emergency again

**English**

**Controls**

1. Cigarette Lighter Socket
2. Optimum Self-Charge Indicator
3. Winder Handle

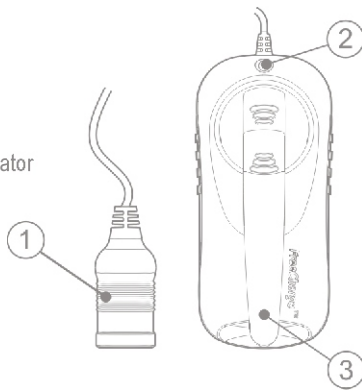

Congratulations on purchasing the Freeplay Eco-Charge FreeCharge 12V

Please read these operating instructions carefully before using your FreeCharge 12V and retain them for easy reference. Record the serial number, to be quoted when dealing with Freeplay or a recognised Freeplay distributor regarding this product:

Serial number: \_\_\_\_\_

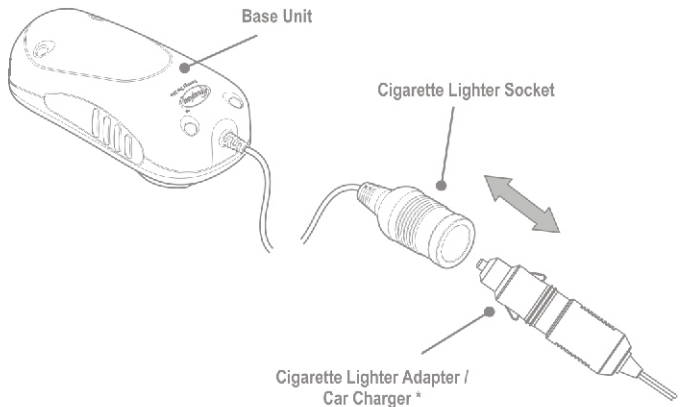

\* NOT SUPPLIED.

**FEATURES**

- Freeplay direct charge generator
- Recharge capability using applicable cigarette lighter adapter
- LED optimum wind level indicator for ease of use
- Generic cigarette lighter socket interface
- Instant power for cellphones and personal electronic devices
- Regulated, clean 12V power supply
- Non damaging to phones
- No degradable components

**PRECAUTIONS**

- When connected to your mobile phone, the FreeCharge 12V may affect mobile phone reception if cranked while placing or receiving a call.
- The charging performance of the FreeCharge 12V may be affected by temperatures below 0°C (60°F) or above 40°C (100°F).
- When cleaning, do not use abrasives or chemicals. Use a damp cloth with mild detergents.
- Do not immerse this product in water.

**OPERATION**

- To charge the phone or other device, use the applicable cigarette lighter adapter (car charger) and insert into the cigarette lighter socket on FreeCharge 12V base unit.
- Flip out the handle and wind clockwise or anticlockwise.
- When the optimum wind effort is achieved (120 rpm-130 rpm) the green optimum self-charge indicator LED will illuminate to indicate charging. It may take up to 5 seconds for the phone to lock onto the incoming charge.
- Talk and standby times provided by the FreeCharge 12V are dependent on the duration of self-charge effort, and the type of mobile phone and cigarette lighter adapter used.
- Performance will vary from user to user - predictable results are identified through experimentation and practice. The longer you wind, the more energy is transferred to the phone.

**SPECIFICATIONS**

**Power Source:**  
 Internal AC alternator driven by crank handle via a transmission

**Performance:**  
 Talk time: 60-second wind 2-4 minutes  
 Talk and standby times provided by Freecharge 12V are dependent on the duration of self-charge effort and the type of mobile phone used and cigarette lighter adapter.

**Dimensions:**  
**Freecharge 12V Base Unit:**  
 Height 54mm 2.1 inches  
 Length 137mm 5.4 inches  
 Width 63mm 2.5 inches  
 Weight 310g 11.5 oz

**Adapter Module:**  
 Weight 40g

**FREEPLAY 2 YEAR WARRANTY**

The manufacturer undertakes that, if within 2 (two) years of purchase, this appliance or any part thereof is proved to be defective by reason of faulty workmanship or materials, we will, at our option repair or replace the same free of charge for labour or materials on condition that:

1. The original invoice or sales receipt (indicating the date of purchase, product type and dealer's name) is presented together with the defective unit.
2. The complete unit is returned to the manufacturer or country distributor, postage paid.
3. The unit has not been serviced, maintained, repaired, taken apart or tampered with by any person not authorised by the manufacturer.
4. All service work is undertaken by the manufacturer or appointed agents.
5. Any defective unit or part shall become the property of the manufacturer.
6. This warranty is in addition to your statutory rights.

This warranty excludes damage caused by misuse or neglect. To register please complete the online registration form at:

[www.freeplayenergy.com](http://www.freeplayenergy.com)  
 Customer Care: [info@freeplayenergy.com](mailto:info@freeplayenergy.com)

To learn more about Freeplay products visit us at:  
[www.freeplayenergy.com](http://www.freeplayenergy.com)

**Please consider the environment before printing this manual**